





QUANTITIES SUBJECT TO CHANGE - CONTACT LDPI FOR AVAILABILITY						
Explosion Proof CID1						
	Series	Classification	Part Number ID	Wattage/Lumens	CCT	On Hand 12.13.24
	LEXS	Explosion Proof CI,D1 / CI,D2 Paint Spray Listed	LEXS-L1-V1-5-V110-D	40W / 3800Lm	5,000K	25
			LEXS-L1-V1-4-V110-D	40W / 3520Lm	4,000K	30
			LEXS-L1-V1-4-V110-C	40W / 4480Lm	4,000K	19
		Accessories	PC01 Pole Mount Pipe Clamp 316 S.S. 1 7/8"			12
			PC02 Pole Mount Pipe Clamp 316 S.S. 2 3/8"			32
	Series	Classification	Part Number ID	Wattage/Lumens	CCT	On Hand 12.13.24
	LEXSG2	Next Generation Explosion Proof	LEXSG2-L4-V1-5-V110-D-PB	80W / 8690Lm	5000K	12
		CI,D1, CI,D2 Paint Spray Listed	LEXSG2-L4-V1-4-V110-D-PB	80W / 8690Lm	4000K	42
CI,D1, CI,D2 Paint Spray Listed		LEXSG2-L4-V1-4-V110-c-PB	80W / 8690Lm	4000K	10	
Explosion Proof CID1						
	Series	Classification	Part Number ID	Wattage/Lumens	CCT	On Hand 12.13.24
	LEXF1	Explosion Proof CI,D1 / CI,D2 CII,D2 / CIII, Paint/Spray Listed	LEXF1-L1-V1-5-T5-C	21W / 4220Lm	5,000K	Currently out of stock
			LEXF1-L2-V1-5-T5-D	40W / 5200Lm	5,000K	14
			LEXF1-L2-V1-5-T5-C	40W / 6500Lm	5,000K	17
			LEXF1-L4-V1-5-T2-C	60W / 7600Lm	5,000K	21
			LEXF1-L4-V1-5-T5-D	60W / 7130Lm	5,000K	22
			LEXF1-L4-V1-5-T5-C	60W / 8510Lm	5,000K	22
Accessories	PB02-BK Yoke Mount				78	
	Series	Classification	Part Number ID	Wattage/Lumens	CCT	On Hand 12.13.24
	LEXF	Explosion Proof CI,D1 / CI,D2 CII,D2 / CIII	LEXF-L1-V1-3-V120-C	80W / 9720Lm	3,000K	2
			LEXF-L2-V1-4-V120-C	100W / 11760Lm	4,000K	13
			LEXF-L3-V1-4-V120-C	150W / 18360Lm	4,000K	22
			LEXF-L3-V1-5-V120-C	150W / 18650Lm	5,000K	2
	Accessories	SN01-BK slip fitter				13
		SN01 slip fitter				Currently out of stock
WG01 Wire Guard					14	
HAZARDOUS CLASSIFICATION CID2, CII D1 and D2, CIII						
	Series	Classification	Part Number ID	Wattage/Lumens	CCT	On Hand 12.13.24
	LEHL1	Hazardous CI,D2 CII,D1&2 CIII	LEHL1-L1-V1-4-V110-C-U	45W / 6375Lm	4,000K	18
			LEHL1-L2-V1-5-V110-C-P	65W / 10150Lm	5,000K	28
			LEHL1-L2-V1-5-V110-D-P	65W / 8650Lm	5,000K	1
LEHL1-L2-V1-5-V110-C-U			65W / 10150Lm	5,000k	6	



SN9002 Stanchion-90° / 1-1/2	16
SN2501 Stanchion - 25° 1 - 1/4	15
SN2502 Stanchion-25° / 1-1/2	14
WG03 SS Wire guard-globe lens	3

HAZARDOUS CLASSIFICATION CID2, CII D1 and D2, CIII



Series	Classification	Part Number ID	Wattage/Lumens	CCT	On Hand 12.13.24
LEHL2	Hazardous CI,D2 CII,D1&2 CIII	LEHL2-L1-V1-5-T5-C-P	80W / 12630Lm	5,000K	23
		LEHL2-L1-V1-5-T5-DP-P	80W / 8830Lm	5,000K	4
		LEHL2-L1-V1-5-T5-DL-P	80W / 12290Lm	5,000K	1
		LEHL2-L2-V1-5-T5-C-P	120W / 19230Lm	5,000K	30
		LEHL2-L2-V1-5-T5-DP-P	120W / 13250Lm	5,000K	10
		LEHL2-L3-V1-5-T5-C-P	150W / 23630Lm	5,000K	22
		LEHL2-L3-V1-5-T5-DL-P	150W / 20950Lm	5,000K	10
		LEHL2-L4-V1-5-T5-C-P	200W / 28940Lm	5,000k	5
		LEHL2-L4-V1-5-T5-DL-P	200W / 27795Lm	5,000k	17
		LEHL2-L4-V1-4-T5-C-P	200W / 28940Lm	4,000k	18
Accessories	SN9003 Stanchion-90° / 1-1/4	29			
	SN9004 Stanchion-90° / 1-1/2	15			
	SN2503 Stanchion - 25° 1 - 1/4	112			
	SN2504 Stanchion-25° / 1-1/2	Currently out of stock			
	WG07 SS Wire guard-flat lens	33			
	WG08 SS Wire guard-globe lens	19			
	SN01 Slipfitter mount bracket	Currently out of stock			
	WL90-M Wall-90°	20			
PB03 U Bracket 304 Stainless Steel	33				



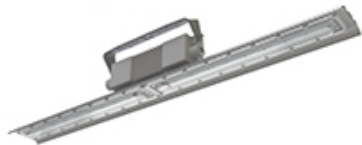

HAZARDOUS CLASSIFICATION CID2, CII D1 and D2, CIII

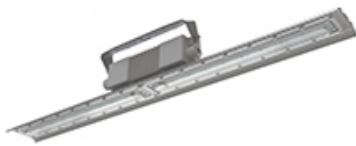



Series	Classification	Part Number ID	Wattage/Lumens	CCT	On Hand 12.13.24
LEHS	Hazardous CI,D2 CII,D1&2 CIII	LEHS-L1-V1-3-V110-D	40W/6180Lm	3,000k	12
		LEHS-L2-V1-5-V110-D	80W / 9930Lm	5,000K	6
		LEHS-L2-V1-4-V110-C	80W / 11350Lm	4,000K	14
		LEHS-L2-V1-5-V110-C-EM	80W / 11490Lm	5,000K	2
	Accessories	HK04 Eyebolt Hanging Kit	37		
		PC01 Stanchion Kit	12		

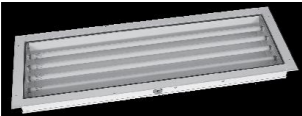

LEHSG2	Next Generation Hazardous	LEHSG2-L2-V1-5-V110-C-PG	40W / 5790Lm	5000K	12
	CID2, CIID1 & CIID2	LEHSG2-L4-V1-5-V110-C-PG	80W / 12,030Lm	4000K	30

ORDINARY LOCATION LED BOOTH FIXTURES						
	Series	Classification	Part Number ID	Wattage/Lumens	CCT	On Hand 12.13.24
	LE180	Ordinary Location	LE180-L2-V1-5-D	75W /9220Lm	5,000K	5
RECESS MOUNT C1D2 LED PAINT AND POWDER BOOTH FIXTURES						
	Series	Classification	Part Number ID	Wattage/Lumens	CCT	On Hand 12.13.24
	LE484	Hazardous CI,D2 / CII,D2 Paint Booth listed	LE484-L1-V1-5-D	75W /8270 Lm	5,000K	201
			LE484-L1-V1-5-T	75W /9070 Lm	5,000K	15
	LE485E (inside access)	Hazardous CI,D2 / CII,D2 Paint Booth listed	LE485E-62-W1-V1-A-5-WH-H	62W/6330	5,000K	41
			LE485E-62-W2-V1-A-5-WH-H	62W/6330	5,000K	Currently out of stock
FLUORESCENT PAINT AND POWDER BOOTH FIXTURES						
	Series	Classification	Part Number ID	Wattage/Lumens	CCT	On Hand 12.13.24
	229H	Ordinary	229H-T8-4L-120-277	32W / T8		51
	SLIM LIGHT (Inside Access)	Hazardous CI,D2 / CII,D2 Paint Booth	390440-3546	32W / T8		141
			400 Series (Rear Access)	390231-3546	17W / T8	
		Hazardous CI,D2 / CII,D2 Paint Booth listed	390441-3546	32W / T8		12



	380 Series	Explosion Proof CI D1& DII / CII D1&2 Paint Booth listed	380-T5HO-2L-4-UNV-EM-HB	54w/T5HO	1	
			380-T8-4L-4-UNV	32w/T8	4	
Lens Film Paint Booth Light Protection						
			Part Number	Dimensions	On Hand 12.13.24	
			3263	12"x100'	14	
			3188	18"x100'	9	
			4348	25"x100'	4	
			3312 Dispensor handle for 12 or 18" roll only		1	
FLUORESCENT NON METALLIC FIXTURES						
Series	Classification	Part Number ID	Wattage/Lumens	Voltage (VAC)	Lens	On Hand 12.13.24
			376-T8-3L-4-UNV-PR	32W / T8	Poly Ribbed	1
			376-T5HO-2L-4-UNV-AC-WD-SL	54W/T5HO	Clear Acrylic	4

*Quick ship items ship approximately 24-48 hours after receipt of an order

**Standard Payment and Freight Terms apply for all